

Hand Pallet Truck

Model: BF-III

1KG=2.205LB 1INCH=25.40MM



Model		BF-III	
Capacity	Q(kg)	2500	2500
Lowered fork height	h_{12} (mm)	85	75
steering wheel	mm	ϕ 180	ϕ 180
fork wheel single	mm	ϕ 74x93	ϕ 74x93
fork wheel double	mm	ϕ 74x70	ϕ 74x70
Max. Lifting height	h_2 (mm)	195	185
Height of tiller in drive position min./max.	h_{14} (mm)	1214	1214
Overall length	l_1 (mm)	1543/1613	1543/1613
Fork length	l (mm)	1150/1220	1150/1220
Width overall forks	b_2 (mm)	520/550/685	520/550/685
Ground clearance, center of wheelbase	m_2 (mm)	32	22
Aisle width for pallets 1000x1200 crossways	A_a (mm)	1743/1813	1743/1813
Aisle width for pallets 800x1200 lengthways	A_a (mm)	1813/1813	1813/1813
Turning radius	W_3 (mm)	1276/1346	1276/1346
Service weight	kg	58-70	58-70

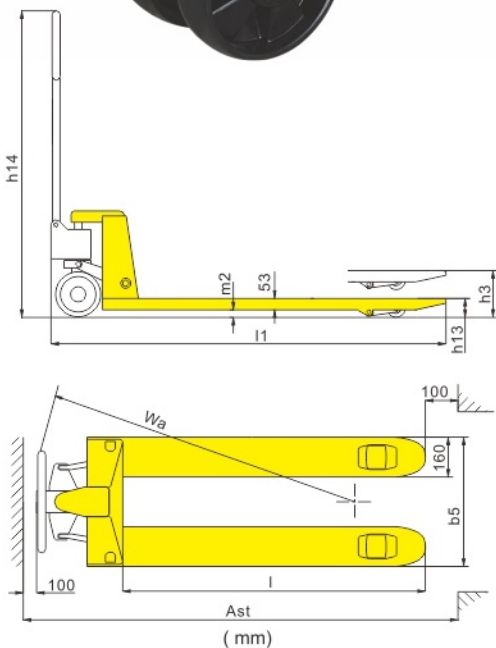

Conforms to EN ISO3691-5:2009
Based on Directive 2006/42/EC



Pump

Hand pallet truck

- Integrated pump without welding , no any leaking problems.
- Frame force is more reasonable , and the strength is more reliable.
- Handle seat has hole it is more convenient for installation of control chain.
- Forks lowering speed is controllable, with overload valve to avoid overloading .